

**RETAIL SPACE**

**519-525 US-46**

Piaget Avenue at Sussex Street

**PIAGET PLAZA**

CLIFTON | NEW JERSEY

**2,650 SF**  
**- 11,650 SF**  
available



**RIPCO**  
REAL ESTATE

## SPACE DETAILS

### LOCATION

525 US-46 (Piaget Avenue at  
Sussex Street)  
Clifton, NJ

### SIZE

End Cap	5,572 SF*
Inline Space	2,650 SF*
dressbarn	9,000 SF*
combined	11,650 SF

\*Divisible

### FRONTAGE

US-46	220'
Sussex Street	432'

### GLA

30,250 SF

### ACREAGE

2.15 acres

### TIMING

dressbarn space available January  
2020

### RENT

Negotiable

### NNN

\$9.50 PSF (est.)

### CO-TENANTS

Discount Liquors, dressbarn,  
Keller Williams, New Sexy  
Nails & Spa

### NEIGHBORS

Dollar Tree, Krauser's  
Food Store, Burger King,  
Spencer's Savings Bank,  
Zen Sushi, La Riveria  
Trattoria, Golden Palace,  
Village News, Bagel Shop,  
Laundromat

### COMMENTS

Located on Main Street,  
just east of the Garden  
State Parkway and west of  
Route 20  
  
Best signage in Clifton

## OBLIQUE AERIAL



**PIAGET PLAZA ACCESS**



**ADDITIONAL PHOTOS**



## AREA DEMOGRAPHICS

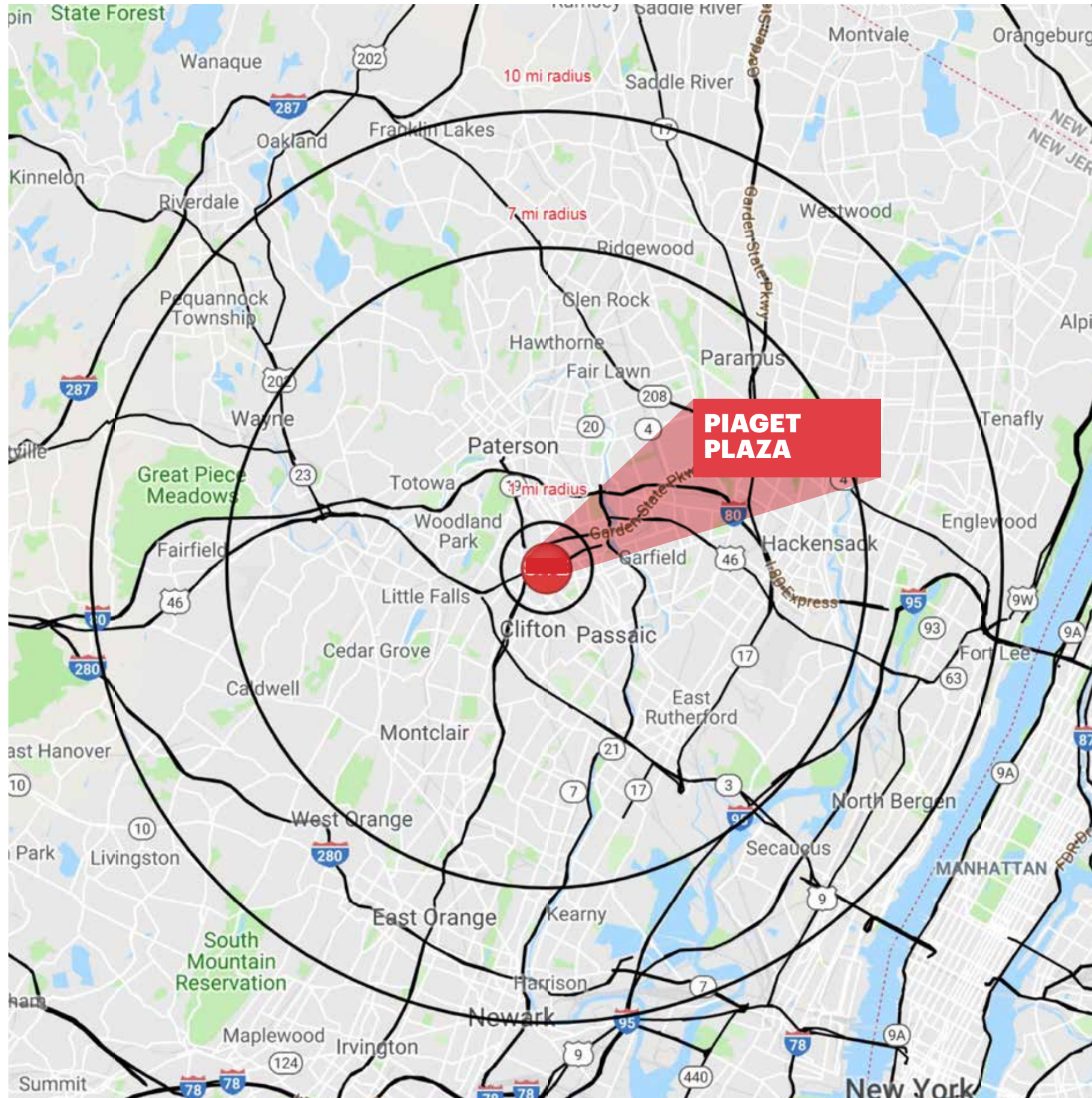

### 1 MILE RADIUS

#### POPULATION

27,440

#### HOUSEHOLDS

9,742

#### MEDIAN AGE

38.5

#### COLLEGE GRADUATES (Bachelor's +)

5,521 - 28.8%

#### TOTAL BUSINESSES

1,434

#### TOTAL EMPLOYEES

11,789

#### AVERAGE HOUSEHOLD INCOME

\$84,922

### 7 MILE RADIUS

#### POPULATION

1,017,511

#### HOUSEHOLDS

370,775

#### MEDIAN AGE

38.1

#### COLLEGE GRADUATES (Bachelor's +)

251,576 - 36%

#### TOTAL BUSINESSES

45,943

#### TOTAL EMPLOYEES

470,678

#### AVERAGE HOUSEHOLD INCOME

\$104,226

### 10 MILE RADIUS

#### POPULATION

1,925,196

#### HOUSEHOLDS

699,076

#### MEDIAN AGE

38.4

#### COLLEGE GRADUATES (Bachelor's +)

492,584 - 37.1%

#### TOTAL BUSINESSES

81,866

#### TOTAL EMPLOYEES

890,009

#### AVERAGE HOUSEHOLD INCOME

\$106,027

# SITE PLAN

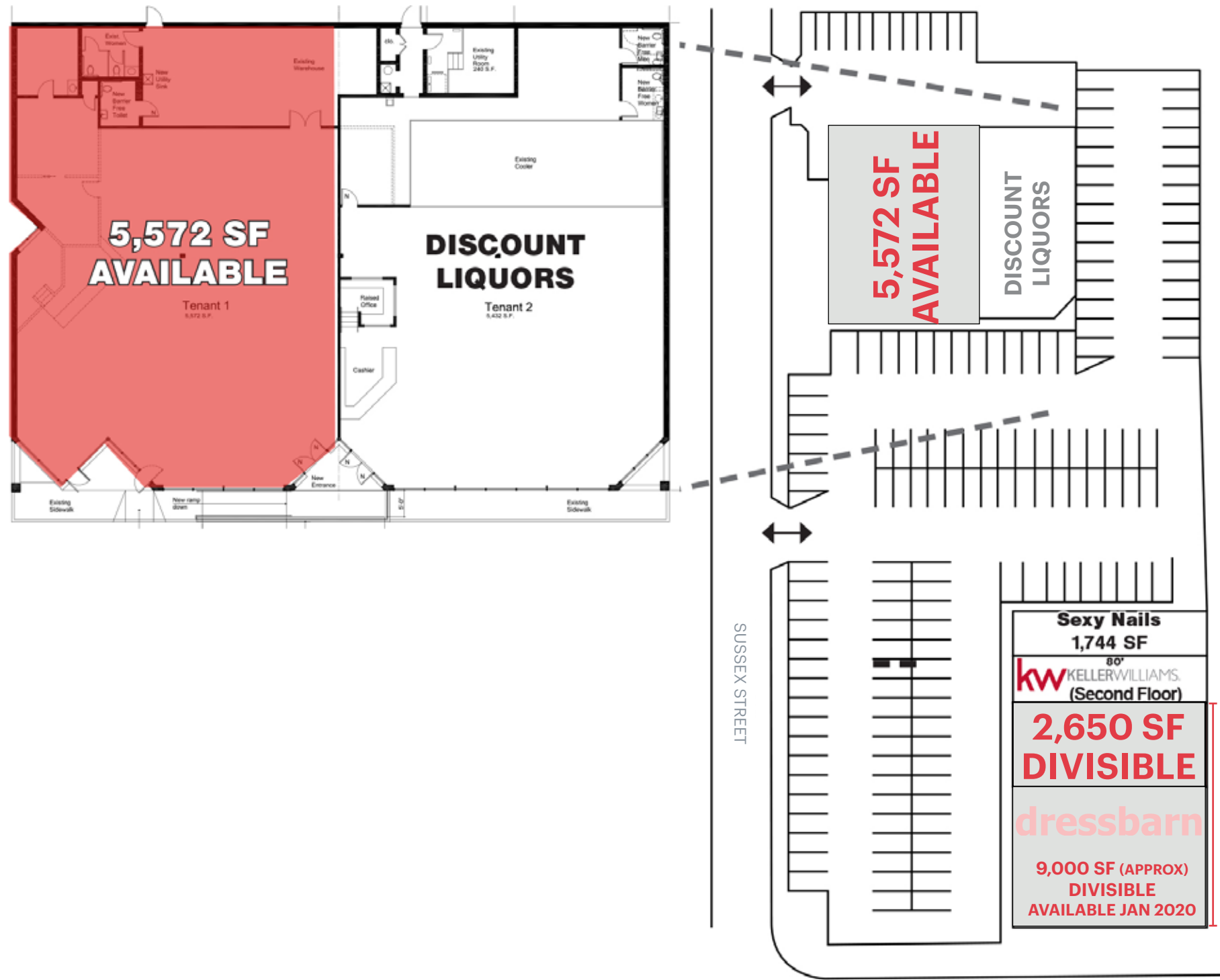

## CONTACT EXCLUSIVE AGENTS

**CURTIS NASSAU**

[cnassau@ripconj.com](mailto:cnassau@ripconj.com) | 201.777.2302

**FLORIAN SUSERMAN**

[fsuserman@ripconj.com](mailto:fsuserman@ripconj.com) | 201.777.2301

**RIPCO**  
REAL ESTATE

125 Chubb Avenue  
Suite 150S  
Lyndhurst, NJ 07071  
201.777.2300

Please visit us at [ripconj.com](http://ripconj.com) for more information

This information has been secured from sources we believe to be reliable, but we make no representations as to the accuracy of the information. References to square footage are approximate. Buyer must verify the information and bears all risk for any inaccuracies.